

Environmental DNA Surface Sampling Instructions

Before you begin, please note that surfaces are a potential source of harmful pathogens. Wear gloves and wash your hands thoroughly after handling surfaces.



Safety

Assume surfaces carry pathogens; wear gloves, avoid preservative contact, wash hands after sampling.



Gloves

Open your kit and place on a fresh pair of gloves.



Get organised

Prepare equipment, identify components, and label sample with site, date, and GPS coordinates.

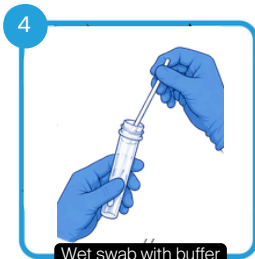

Wet swab with buffer

Open the preservation buffer and pre-wet the swab with preservation buffer.



Sampling

Swab all surfaces likely contacted by animals, rotating to expose all swab sides; discoloration is fine.

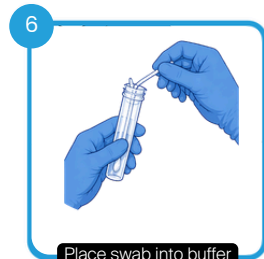

Place swab into buffer

Replace the preservative buffer cap and firmly tighten.



Tighten the cap

Firmly tighten preservative cap and repeat sampling process if required for replicate samples/swabs



Repeat with replicate

Repeat sampling process with a second swab and preservative buffer.



Send samples

Place sealed tubes in zip-lock bag with labeled data; ensure details complete and remove all waste.

Once replicates and sampling is complete, send to EnviroDNA:
Level 1, 95 Albert Street, Brunswick VIC 3056

Environmental DNA Scat Sampling Instructions (Swab method)

Before you begin, please note that scats are a potential source of harmful pathogens. Wear gloves and wash your hands thoroughly after handling scats.



Gloves
Open the sampling kit and put the gloves on

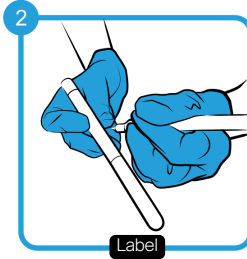

Label
Clearly label sample with the site, date, and GPS co-ordinates



Wet swab with preservative
Open preservative and pre-wet the swab with preservation buffer



Swab scat
Swab scat lengthways 6-10 times, then break open scat and swab 6-10 times. Rotate swab so all sides are exposed

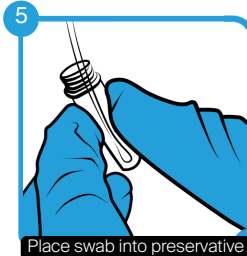

Place swab into preservative
Once swab is thoroughly exposed, place swab back into preservative buffer

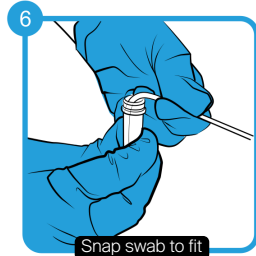

Snap swab to fit
Snap the swab stick at a length that fits within the preservative tube when replacing the tube cap

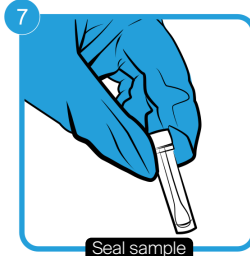

Seal sample
Firmly tighten preservative cap and repeat sampling process if required for replicate samples/swabs



Site label
Place samples into kit and fill out site label. Ensure all details have been filled out (site, date, GPS co-ordinates)

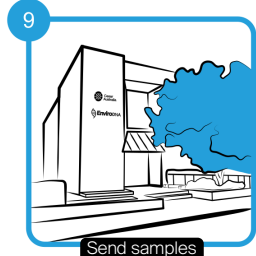

Send samples
Once replicates and sampling is complete, send to EnviroDNA: Level 1, 95 Albert Street, Brunswick VIC 3056

There are two methods of scat sampling available. Please speak with your EnviroDNA Project Manager to discuss your options.